

# Installation Manual

FORD S-MAX 5DR  
FOR-SMAX-5-C



## COMPONENTS INCLUDED

## SHADES

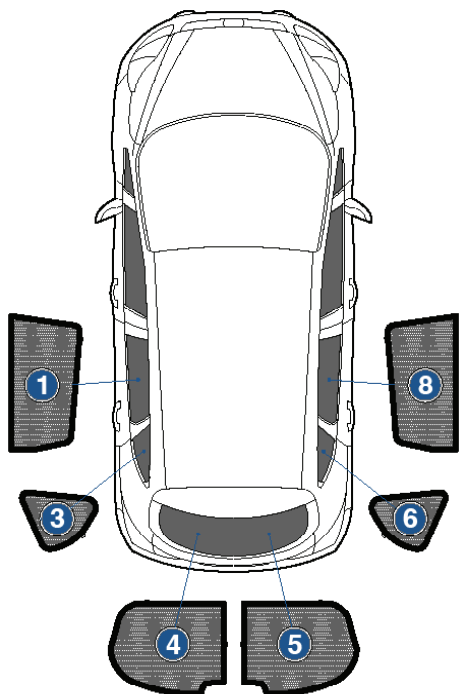

## FIXING CLIPS



CL-M03 x 4



CL-M12 x 10



CL-M14 x 1

# Side Shade Installation

FORD S-MAX 5DR  
FOR-SMAX-5-C

COMPONENTS NEEDED:



## STEP #1

ATTACH CLIPS ON SHADE EDGES



## STEP #2

POSITION THE SIDE SHADE

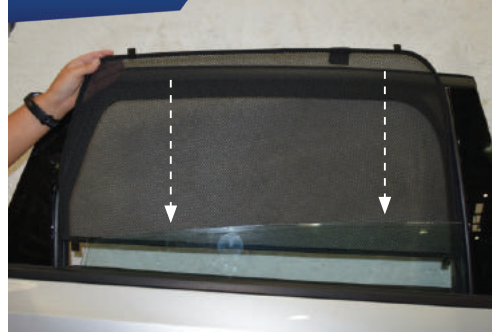

## STEP #3

INSERT CLIPS INSIDE WEATHERSTRIP

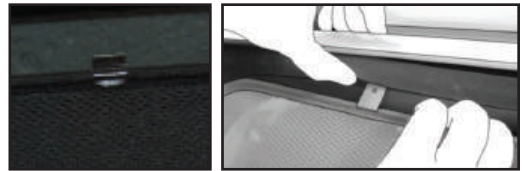
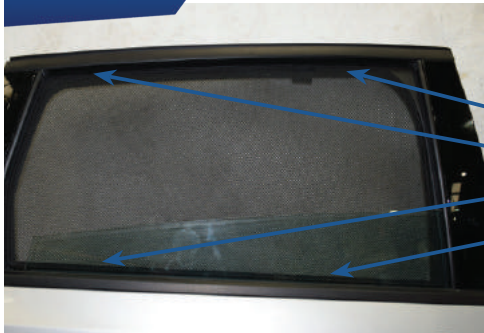

## STEP #4

ENSURE SECURELY FITTED IN PLACE

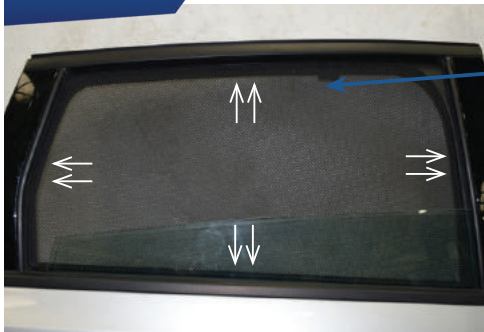

**CAR**  
SHADES

# Quarter Light Shade Installation

FORD S-MAX 5DR  
FOR-SMAX-5-C

COMPONENTS NEEDED:



## STEP #1

ENSURE SECURELY FITTED IN PLACE

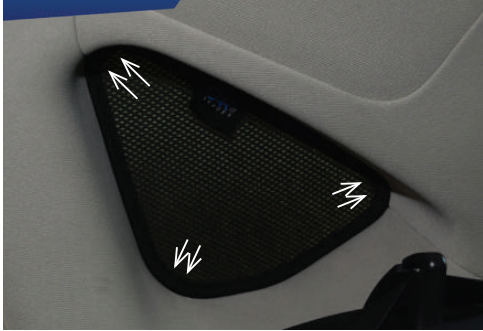

# Rear Shade Installation

FORD S-MAX 5DR  
FOR-SMAX-5-C

## COMPONENTS NEEDED:



### STEP #1

ATTACH CLIPS ON SHADE EDGES



### STEP #2

POSITION THE REAR SHADE

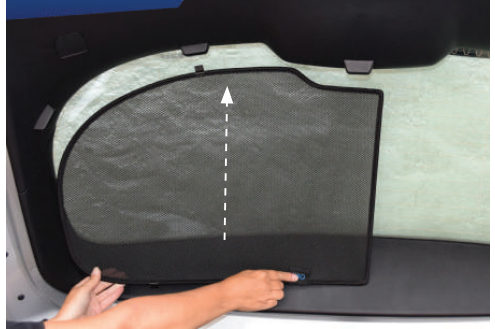

### STEP #3

INSERT CLIPS BEHIND INTERIOR TRIM

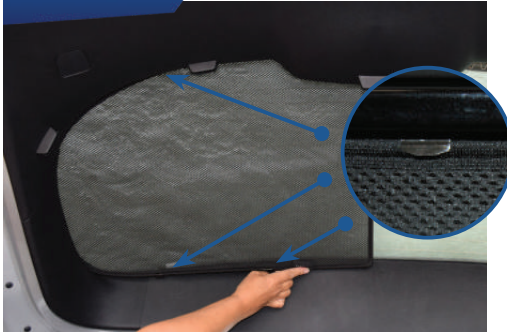

### STEP #4

REPEAT THE PROCESS ON OTHER SHADE

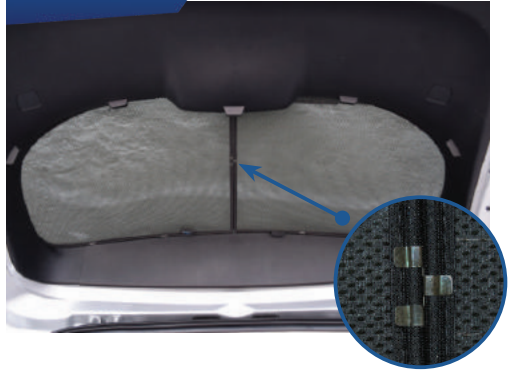

### STEP #5

ENSURE SECURELY FITTED IN PLACE

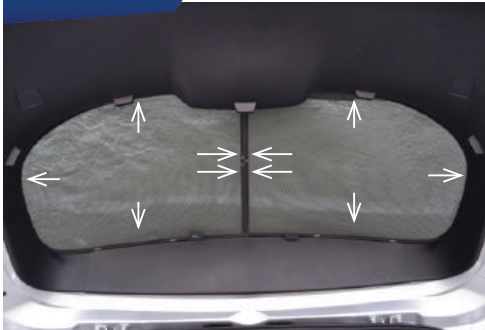

**CAR**  
SHADES